

BJ-EX46 SHX Soap Bubble Machine

Instructions manual



 **BJ Live!**
smart solutions that suit you



BJ-EX46 SHX Soap Bubble Machine

Instructions manual

1_Components of SHX Soap Bubble Machine



SHX Bubbles



Enabler Socket+

2_Configuration of SHX Bubbles and Enabler Socket+

Remove the product's packaging in a suitable way



Please read the whole manual to familiarise yourself with the characteristics before using the device.

1.1_Contents

Unpack the products from their boxes and check the contents. Enclosed with SHX Bubbles there should be a 220V (AC) 50Hz to 3V (DC) adapter and a user manual, in another box there should be an enabler socket+ with its instruction manual. It is recommended to keep the boxes for the duration of the warranty period in case you need to use them again. If you want to dispose of the packaging, please do so responsibly.

If you find any damage or any material is missing when you unpack the kit, please contact your distributor for assistance. Any damage or breakage caused during transport must be notified within three days of receipt.

The SHX Bubbles device can only be used where there is a power socket.

1.2_Specifications of the SHX Bubbles

Adapter 240V (AC) 50Hz to 3V (DC)

2_ Instructions for use

The SHX Bubbles is ready for use so you just have to connect the adapter and then the adapter to the socket plus+ so it can be used with the SHX system.



BJ-EX46 SHX Soap Bubble Machine

Instructions manual

The Enabler Socket+ used for the SHX Bubbles should have the **blue selector in position 2** and the **yellow selector in position from 1 to F** (Timed), depending on the time the device should be on.

Function selector position	Operating mode
0	Latched
1	Timed 1s
2	Timed 2s
3	Timed 3s
4	Timed 5s
5	Timed 10s
6	Timed 15s

7	Timed 30s
8	Timed 45s
9	Timed 60s
A	Timed 1min 30s
B	Timed 2min
C	Timed 2min 30s
D	Timed 3min
E	Timed 4min
F	Timed 5min

The configuration of the Enabler Socket+ is preset in the SHX control software:

Act code 30
On code 76
Off code 60

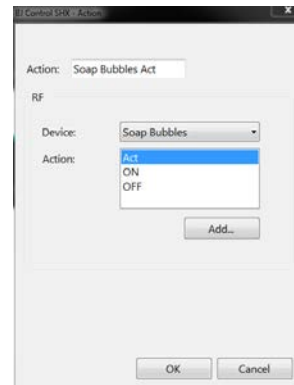

3_Positioning

We recommend placing the Soap Bubble machine close to the ceiling on a shelf, so that it is possible to see the effect of the soap bubbles falling down. If there's a SHX fan in the room, the SHX fan can increase the effect of the soap bubbles by blowing them in different directions.



BJ-EX46 SHX Soap Bubble Machine

Instructions manual

4_Cleaning and Maintenance

Clean the SHX Bubbles regularly to ensure good hygiene. It must be disconnected from the power supply before cleaning. Clean using soapy water and a soft cloth (wrung out). Never use chemical or abrasive products for cleaning. Thoroughly dry and wait one hour to connect to the power supply

5_Regular Inspections



The product should always be used under adult supervision.

A periodic inspection of the devices is recommended; if any faults are detected contact your distributor for assistance.

6_Safety Guidelines

Correct and supervised use of this equipment will ensure it can be used for a long time.

The SHX Bubbles is designed to create a sensitive effect, it is not designed for direct use with users so it should never be shaken, overturned or hit with hard objects.

IMPORTANT: Never leave users without adult supervision while using this product. Suitable for use in therapies with several users simultaneously.

smart solutions that suit you

